

Pool Houses



Homestead
COLLECTION



Welcome

When you're ready to complete your backyard oasis – we can help.

Are you looking to create a relaxing getaway in your very own backyard? Perhaps you're looking to design the perfect outdoor entertainment space for parties? Or maybe you just need a little extra storage for all those pool supplies! Whether you're looking for outdoor living solutions or just extra storage, Homestead can help you design the perfect pool house or pavilion for your property.

Pricing to fit your budget

Homestead offers high end custom designs as well as economy options to make sure you wind up with the pool house of your dreams and your budget

Pool houses built to last

Invest in a Homestead pool house that's built with the same grade of construction materials and skilled approach that you'd use to build your house.

Decades of experience

Your dream pool house becomes reality with the quality that comes from years of experience by multi-generational Amish craftsmen in Lancaster County.



About Us	3
Foundation	4
Delivery	5
Siesta	6,7
Avalon	8,9
Heritage	10-11
Wellington	12-13
Pool Sheds	14-15
Pavilions	16-17
Custom Timber Frame Buildings	18-19
Custom Built Pool Houses	20-21
Options	22-23

About Us

The Homestead Story

Homestead Structures started in 2003 as a sideline business to our dairy farm in order to support our family and others in the community. We started with building barns and structures for our Amish brethren, but quickly saw that there was a need and desire in Central PA and beyond for well-made, aesthetically pleasing garages, sheds, pool houses, and more.

We are designers, craftsmen, and builders. We specialize in solving your storage and outdoor living needs with highly customized buildings that reflect attention to detail and craftsmanship. If you have a vision for your new pool house, shed or garage, we'd love to help you bring it to life!



Our Family

Our owner Steve and his wife Martha have nine children, most of which are involved in the family business or farm. Their children hold a variety of jobs, from teachers in a 1-room Amish schoolhouse to apprenticing in the production shop and working as Farm and House Managers to keep the farm running smoothly.

We continue to expand our work family with seasoned craftsmen and builders. Most hail from our local community and many walk to work. Our shop opens at 6:00A and closes up around 5:00P to give our team time to spend with their family every evening.

Our Mission & Vision

We are a family-owned and -operated company, founded on biblical principles. We provide high-quality building solutions that solve our customers' needs, both functionally and aesthetically improving their outdoor living and entertainment spaces.

Our vision is to be the company of choice in the industry by providing excellent service to our customers in a God-honoring way.

Laying the Foundation

Get the longest life out of your pool house with the proper choice in foundation

The first step to a quality, long lasting pool house or pavilion is choosing the proper foundation. Your foundation helps ensure your structure withstands the test of time, and can help prevent:

- Water damage as it filters rain away.
- Doors and windows from closing or hanging improperly.
- Structural damage such as your floor sagging or warping.
- Rodents and pests from deciding your structure is a great new home!

The size and dimensions of your pool house may determine which foundation is best for your project. Regardless of the foundation, make sure the ground is compacted, leveled, and has good drainage to eliminate shifting and settling.

Your area's zoning and permit laws may also determine the type of foundation you can use, so be sure to check with your local offices to find out.

Gravel Bed Foundation



Footer Block Foundation



Gravel & Stone Bed Foundations

For smaller pool houses or sheds that remain on skids (often seen as a "temporary" structure), a gravel or stone bed foundation will suffice.

Dig 4 to 8 inches down (below the frost line) and compact the ground. Ensure the dimensions of your pad give you an extra foot of bed around your structure. (This helps prevent rot and ensures excess water will drain away from the structure.) For a clean border, install an outer frame of pressure treated 2" x 6" or 4" x 6" wood around the perimeter of the pad.

Concrete Foundations

Large or permanent pool houses and pavilions need a concrete foundation. Concrete slabs mean your structure won't settle or shift, and allows you to forgo wood flooring and simply use the concrete slab as the floor if you prefer.

Concrete foundations should be installed by a professional and can take several days to complete.

Types of concrete foundations include:

- The Gibraltar – reinforced with rebar, cement walls, concrete slab, and gravel base for drainage.
- The Graduated Slab – includes rebar, a concrete slab, and a gravel base for drainage.
- The Floating Slab – similar to the Graduated slab, but without trenches.
- Concrete Pillars – include concrete tube formers, rebar, poured concrete, and metal strapping. Also used in conjunction with a gravel or stone bed.

We are happy to offer our foundation services along with the design and building of your new pool house. Please call us at 877-272-7252 for more information!

Delivery Options

Keeping the set up of your new pool house as easy and efficient as possible

The size and weight of your pool house or pavilion will determine which delivery process will work best. For small structures, we can usually prefabricate your building on our site in a controlled environment and deliver it complete and ready to be placed on a prepared foundation.

For larger, more custom and complex structures, our team of experts will build your new pool house on-site before your eyes.

What to Expect for Delivery of a Pre-Fab Pool House or Pavilion:

- Once the details of the structure are decided, we'll call to schedule a delivery date.
- You'll receive a reminder call, email, or text one to two days before delivery date.
- The driver will call 30 minutes to an hour before arriving on the day of delivery.
- A MULE forklift may be used to place the pool house or pavilion for minimal impact to your property.

What to Expect When Your Pool House or Pavilion is Built On-Site:

- A crew of 3-4 builders will be on-site in the morning (unless otherwise scheduled) with raw materials. (We can also bring pre-cut materials to simply construct on site – your choice).
- Your Crew Foreman will provide daily updates to you so you'll always know where we're at in the process.
- The Foreman will be available to answer your questions or discuss any issues that arise then and there.
- The job site will be straightened and organized at the end of each day as needed and completely cleaned up at the end of the job.



Looking for the perfect place to gather friends and family on warm summer nights? Our Siesta Poolside Bars feature an inviting bar area to sit and relax while enjoying drinks and conversation. Also providing for practical

needs, this design includes space for storage and privacy, combining hospitality and entertainment into one fun package.



Siesta Poolside Bar

When Entertaining and Storage Are Both a Priority

THE SIESTA COMES STANDARD WITH:

Single Solid House Door, Two 24" x 36" Windows, Bar Counter, 2 Vinyl Columns

It was so easy to work with Homestead Structures. We told them everything we wanted and they came through with everything we asked for. From start to finish, we knew what we were getting, how much everything costs, when delivery would be, everything was great! We couldn't have had a better experience, and we love our Siesta!
-Suzanne I.

Summer Fun

Reinvent Your Poolside Space



Siesta Poolside Bar / 12' x 14'

Ivory Vinyl Siding, White Trim, Dual Brown Shingles
Options Shown: Tile Countertop, Special Layout with 14' Bar Front, Vinyl Board & Batten on Bar Front, Vinyl Board & Batten on Wall behind Bar, Cutout for Fridge, Electrical Package, Light/Fan Combo



Siesta Poolside Bar / 10' x 12'

Clay Vinyl Siding, Navajo Trim, Driftwood Shingles
Options Shown: 2' Extended Roof Overhang, Stone Veneer on Bar Front, Mahogany Stained D-Temp on Wall Behind Bar, 11-Lite Door, Granite Countertop, Electrical Package, Light/Fan Combo



Siesta Poolside Bar / 10' x 12'

Antique Parchment Vinyl Siding, White Trim, Weatherwood Shingles
Options Shown: Stone Veneer on Bar & Back Wall, Tile Countertop, TV, Electrical Package, Light/Fan Combo



Siesta Poolside Bar / 10' x 12'

Blue Vinyl Siding, White Trim, Blue Shingles
Options Shown: Stone Veneer on Bar & Back Wall, Tile Countertop, TV, Electrical Package, Light/Fan Combo

Large Photo:

Siesta Poolside Bar 10' x 12'

Sand Vinyl Siding, White Trim, Weatherwood Shingles
Options Shown: DuraTemp on Back Wall, TV, Tile Counter, Stone Veneer on Bar Front, Electrical Package, Light/Fan Combo

With timeless style and versatility, the Avalon Pool House complements a backyard retreat as an elegant pavilion blended with all the amenities of a pool house. With a design that lends itself well to entertaining

guests or enjoying family time by the pool, the Avalon is the perfect addition to create an outdoor living space with all the comforts of home.



Avalon Pool House

The Perfect Blend of Indoor & Outdoor Entertainment Space

THE AVALON COMES STANDARD WITH:

Single Solid House Door, Two 24" x 36" Windows, Two 8" Round Vinyl Columns

I wanted to share the most positive experience I had working with Homestead Structures. From my first contact, until the end of the project, your team answered all my questions in a timely and courteous manner. Homestead

integrated seamlessly with my pool project. Other contractors who saw the pool house said the craftsmanship was of high quality. I would highly recommend Homestead Structures without reservation! - Lou

Summer Lounging

Relaxation At It's Most Elegant



Avalon Pool House / 10' x 14'

White Siding, White Trim, Slate Shingles
Options Shown: Back Wall, Bar with Stone Veneer, Tile Countertop, Electrical Package, Light/Fan Combo



Avalon Pool House / 18' x 26'

Clay Vinyl Siding, White Trim, Driftwood Shingles
Options Shown: 15-Lite Double Door, 9-Lite House Door, Bathroom Upgrade in Enclosed Area, 30" Carlisle Cupola, Electrical Package



Avalon Pool House / 18' x 20'

Clay Vinyl Siding, White Trim, Slate Shingles
Options Shown: Vinyl Shake Siding, Square Columns, Custom Windows & Doors, Bar Counter & Custom Interior Kitchen with Bathroom & Changing Room.



Avalon Pool House / 12' x 22'

White Vinyl Siding, White Trim, Slate Architectural Shingles
Options Shown: Back Wall, Partial Side Wall, 9-Lite House Door, 30" Carlisle Cupola, Copper Weathervane, Granite Countertop, Bar Counter with Stone Veneer

Large Photo:

Avalon Pool House 12' x 18'

White Vinyl Siding, White Trim, Black Shingles
Options Shown: Bar Window Upgrade, 15-Lite Double Door.

Echoing a classic southern feel, the Heritage Pool House features a spacious design with doors and windows for excellent cross-ventilation and natural lighting, as well as optional porch columns. Available with

upgrades for personalization and style, the Heritage is an elegant backdrop for poolside parties and gatherings, providing functional space for practical needs while complementing any natural outdoor setting.



Heritage Pool House

Bring the Comforts of Home to Your Poolside

THE HERITAGE COMES STANDARD WITH:

Double Door with 15-Lite Glass, Two 24" x 36" Windows, 3' Porch with Two 8" Round Vinyl Columns

What convinced me that it was the right decision to go with Homestead Structures was my first interface with Steve, going to their facility, and looking at the quality of the workmanship and the options that were provided to us. I think the other big part of it for me was the ability to get exactly what we wanted. Most places you go, there's a book where you're going to "xyz" and here we were able to select all types of options for our Heritage....

Ed H.

Summer Style

Bring Southern Class To Your Pool



Heritage Liberty Pool House / 15' x 18'

Sand Vinyl Siding, Clay Trim, Driftwood Architectural Shingles
Options Shown: Clay Doors, Extra 15-Lite Double Door, Vinyl Shake Siding, 7' Windsor Dormer with 1/2 Round Window



Heritage Liberty Pool House / 15' x 14'

Clay D-Temp Siding, White Trim, Slate Architectural Shingles
Options Shown: Vinyl Window Upgrade, 2 Extra Windows, 2 Extra Transom Windows, 24" Carlise Cupola, Copper Eagle Weathervane, 3 Transom Mini Dormer, Lap Siding on Front



Heritage Classic Pool House / 12' x 12'

White Vinyl Siding, White Trim, Slate Shingles
Options Shown: 7' Windsor Dormer with 1/2 Round Window, Porch Floor with Composite Decking



Heritage Liberty Pool House / 16' x 14'

Special Siding, White Trim, Special Shingles
Options Shown: 1 Extra 24" x 36" Window, 2 Extra Transom Windows, Stucco Exterior Upgrade, Stone Veneer (Special), 24" Carlise Cupola, 12/12 Roof Pitch, 4' x 14' Porch Upgrade, 3 Transom Mini Dormer

Large Photo:

Heritage Liberty Pool House 17' x 20'

Clay Vinyl Siding, White Trim, Driftwood Shingles
Options Shown: 2 Extra 15-Lite Double Doors, 2-40" x 60" Vinyl Window Upgrade, 3 extra 30" x 10" Vinyl Transom Windows, 7' Windsor Dormer with 1/2 Round Window

A classic and tasteful design tailored for parties and outdoor gatherings, the Wellington Pool House is an elegant addition to any outdoor venue or home space. Completely customizable in size and upgrades, this pool

house blends functional amenities such as walk-in showers, outdoor or indoor kitchens and bar space, with luxurious comfort and style for the perfect outdoor entertainment space.



Wellington Pool House

A Distinctive Structure for Any Backyard

THE WELLINGTON COMES STANDARD WITH:

Double Door with 15-Lite Glass, Single House Door with 15-Lite Glass, Two 30" x 36" Windows,
One 8" Round Vinyl Column, False Reverse Gable

We had Homestead Structures build a Wellington pool house as part of a new in-ground pool project. We visited Homestead Structures for the initial planning. The rest was done by email and phone with quick turn around on revisions. The guys worked from 7AM till dusk every day to get the project done! The workmanship was excellent and the entire project was a pleasant experience. We love the pool house and I enthusiastically recommend Homestead to anyone considering a backyard structure!

- Ken J.

Summer Love

Build Memories That Will Last A Lifetime



Wellington Pool House / 16' x 20'

Stucco Siding, White Trim, Upgraded Shingles

Options Shown: Bar with Granite Countertop, Stone Veneer, Stone Pier



Wellington Pool House / 24' x 36'

Cream Vinyl Siding, White Trim, Dual Black Shingles

Options Shown: Bar with Tile Countertop, Extra Window, Garage Area, ½ Round Window in Reverse



Wellington Pool House / 16' x 24'

Vintage Wicker Vinyl Siding, White Trim, Dual Black Shingles

Options Shown: ½ Round Window in Reverse, 12" Higher Walls, Arched Beam Trim



Wellington Pool House / 16' x 22'

Ivory Vinyl Siding, White Trim, Weatherwood Shingles

Options Shown: Extra Overhead Door, Bar with Tile Countertop, Azek Beadboard Bar Front

Large Photo:

Wellington Pool House 16' x 20'

Stucco Siding, White Trim, Driftwood Shingles

Options Shown: Extra Window, Bar with Granite Countertop, Grill in Bar, Drystack Stone Veneer, Stone Pier, Cypress Exterior Shower.

A proven classic, the Homestead Pool Shed blends the convenience of storage and functionality while creating a truly beautiful addition to your pool. Our pool sheds are

customizable and available with tons of options, including roof style, size, and siding type. This pool shed is the ultimate all-American design.



Pool Sheds

A Beautiful Solution for Your Pool Storage Problems

The craftsmanship on our shed is excellent and we are so pleased that we chose The Homestead Collection.
- Josephine and Tom K.

Summer Classics

Beautify Your Poolside



Classic A-Frame / 12' x 18'

Avocado Siding, Almond Trim, Cedar Shake Roof, Red Shutters
Options Shown: 5' Arched Mahogany Double Doors, 4-9-Lite Wood Windows, 4 Wood Raised Panel Shutters, Cedar Shake Siding (Painted), Cedar Shake Roof, 18" Cupola, 9/12 Roof Pitch, Porch Lights



Liberty Hip Roof / 12' x 20'

White Vinyl Siding, White Trim, Slate Shingles
Options Shown: Double 15-Lite Double House Door, Two 30"x36" Window Upgrades, 6' Wood Bi-Fold Window with Shelf, 24" Carlisle Cupola, Cypress Wood Shutters, Bar Shelf, Flower Boxes



Classic Hip Roof / 8' x 12'

Special Vinyl Shake Siding, White Azek Trim, Black Shingles
Options Shown: Arched 15-Lite Double House Door, 34" Carlisle Cupola



Pentacle / 10'

White Siding, White Trim, Black Shingles
Options Shown: Arched 15-Lite Double House Door, Arched Wood Shutters, Campanile Roof

Large Photo:

Premier Garden Series: Williamsburg Hip 10' x 18'

Beaded Cypress Siding, White Trim, Cedar Shingles
Options Shown: Two 9-Lite Wood Windows, One 12-Lite Wood Window, Arched Mahogany French Door, 3 Flower Boxes, 30" Carlisle Cupola

With a gorgeous open-air design and limitless options, Homestead Pavilions combine the nostalgic charm of fun family gatherings and summertime BBQs with chic and elegant designs to make it a beautiful focal point for your backyard. With plenty of

space, you can customize your pavilion any way you want – keep it simple and spacious, or customize with a bar, outdoor kitchen, or fireplace. Either way, you'll be able to enjoy your backyard in rain or shine!



Pavilions

Elegant Beauty for Relaxing and Entertaining

Your guys and the crew were very pleasant to work with. It was a pleasure having them at OUR Homestead and getting to watch them complete our new pavilion. We're thrilled!
- Bill and Mina P.

Summer Days

Stay Shady And Cool



Vintage Pavilion / 12' x 16'

White Trim, Charcoal Gray Shingles

Options Shown: 10" Tapered Column Upgrades, Crown Molding Trim, Dental Braces



Estate Pavilion / 10' x 14'

White Trim, Slate Shingles

Options Shown: 8" Tapered Column Upgrades, 24" Carlise Cupola, Copper Eagle Weathervane



Belvedere Pavilion / 12' x 20'

White Trim, Cedar Shingles

Options Shown: Belle Cupola, Electrical Package



Vinyl Pergola / 10' x 18'

White Vinyl

Large Photo:

Vintage Pavilion / 12' x 36'

White Trim, Rivera Red Shingles

Options Shown: Electrical Package, 24" Morton Cupola, Copper Weathervane.

Bring the natural warmth and beauty of wood to your home with a Timber Frame Pavilion, Pool House, or Shed from Homestead Structures. Combining state of the art precision with centuries old craftsmanship,

your new timber frame building will give you lasting beauty and years of enjoyment. Creating an organic living space in your backyard has never looked so good!



Custom Timber Frame

Bringing the Natural Beauty of Wood to Your Outdoor Living



Summer Spirit

Enhancing Your Yard's Natural Beauty



Timber Frame Pavilion / 12' x 20'

Options Shown: Stone Wall with Fireplace, Black Metal Roof



Interior Details

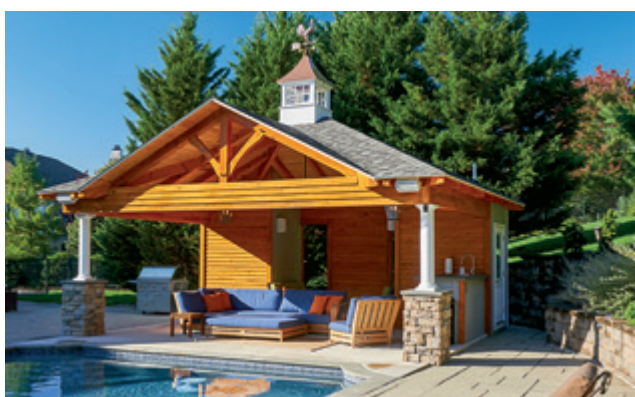

Timber Frame Avalon Pool House / 18' x 22'

Options Shown: Cedar Stain, Slate Shingles, Stone Piers, Bar with Sink, Changing Room and Bathroom, 30" Carlisle Cupola with Weathervane, Electrical Package



Timber Frame Pavilion / 14' x 16'

Options Shown: Bronze Standing Seam Roof, Mission Brown Stain, Electrical Package, Stone Wall, Stone Piers, Fireplace

Large Photo:

Timber Frame Pavilion 16' x 32'

Options Shown: Hip Roof, Stone Piers, Fireplace, Enclosed Room with Stone Veneer Exterior

If you can dream it, we can build it. You don't have to limit yourself when it comes to your new pool house. We'll work with you to develop a customized design based on your

ideas or sketches for the ultimate pool house that reflects your unique style and needs. Transform your backyard into the perfect entertainment oasis!



Custom Built Pool Houses

Have the Pool House You've Always Dreamed Of



Step 1

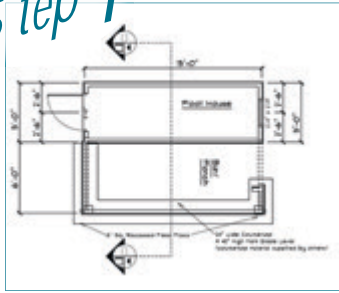

2-D Drawing

Step 2



3-D Rendering

Step 3

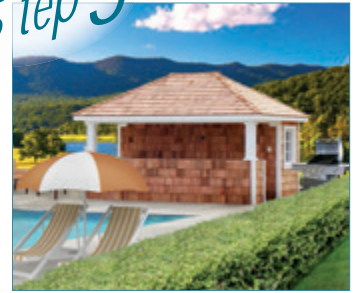

Success!

We decided to put together a space for our family to engage the exterior with the interior. The process of creating our pavilion began with taking natural elements of the shore combined with the elements of our home. Homestead found everything we needed from custom stone, cedar wood for the ceiling, stone countertops, the perfect slate for the roof and all the appliances. Whatever we wanted, Homestead said they could find it for us, and they did!

- Kim R.



Custom Pool House / 14' x 16'
With Bar and Back Wall



Interior Details



Custom Pavilion / 20' x 20'
With Bar and Outdoor Kitchen



Interior Details

Large Photo:

Custom Pavilion 18' x 18'

With Bar, Grill, Pizza Oven and Custom Stone

Options

Choose your options below or tell us what you want and we'll make it happen.

Doors



9-Lite Door

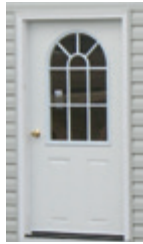

11-Lite Door

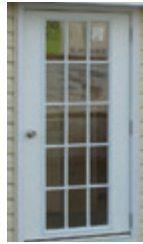

15-Lite Door

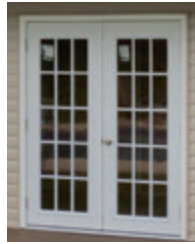

15-Lite Double Doors



Origin Bi-Fold Doors

Flooring



Linoleum Floor
(Wood or Tile Look)



Tile Floor



Laminate Floor

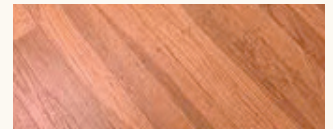

Hardwood Floor

Bathrooms & Showers



Bathroom with
Washbowl



Changing Nook



Exterior Walk-in
Shower



Exterior Shower
with Door

Outdoor Kitchen Options



Inset Grill & Cabinets



Pizza Oven & Grill



Interior Kitchen

Interior Walls



Pine T&G Stained
(white washed)

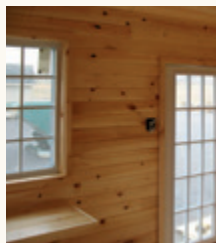

Pine T&G Interior

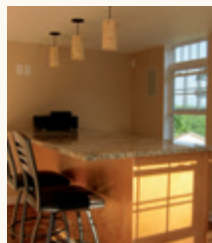

Drywall Interior



Cedar Ceiling
(stained)

Dormers



7' Windsor Dormer with Half
Round Window



10' Windsor Dormer with
Double Transoms

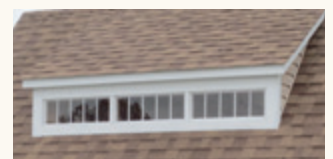

3 Transom Mini Dormer

Exterior Siding & Walls



Vinyl Board & Batten Siding on Bar Exterior



D-Temp Siding on Bar Exterior



Cut Cobble Stone



Natural Ledge Stone



Natural Dry Stack

Lighting & Fans



Vanity Lights



Recess Lights



Porch Lights



Dome Lights



Ceiling Fan w/Light

Cupolas & Weather vanes



Fairfield Cupola



Carlise Cupola

Cabinet Doors

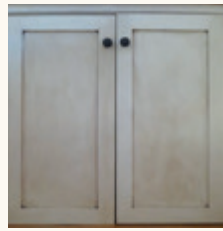

Shaker Cabinet Doors - Painted



Country Cabinet Doors - Painted

Columns

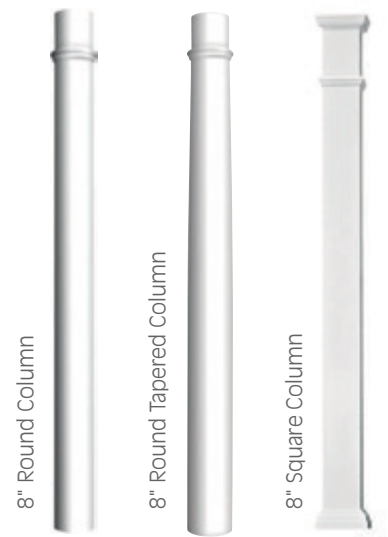

Countertops



Composite Countertop



Tile Countertop



Granite Countertop

Painted Trim Colors



Vinyl Siding Colors



Vinyl Siding Colors



LIVE OUTDOORS

USE YOUR OUTDOOR SPACE TO IT'S FULLEST POTENTIAL



Siesta Poolside Bar 12' x 12'

Cape Cod Gray Vinyl Siding, White Trim, Charcoal Gray Shingles
Options Shown : 2' Extended Roof Overhang, DuraTemp on Bar Front
and Back Wall, Bar Sink, Interior Finish with Bathroom, Electrical
Package, 12' x 10' Attached Vinyl Pergola



Homestead
COLLECTION